

### 3 Projection Hex Weld Nuts - Din 929 Specs

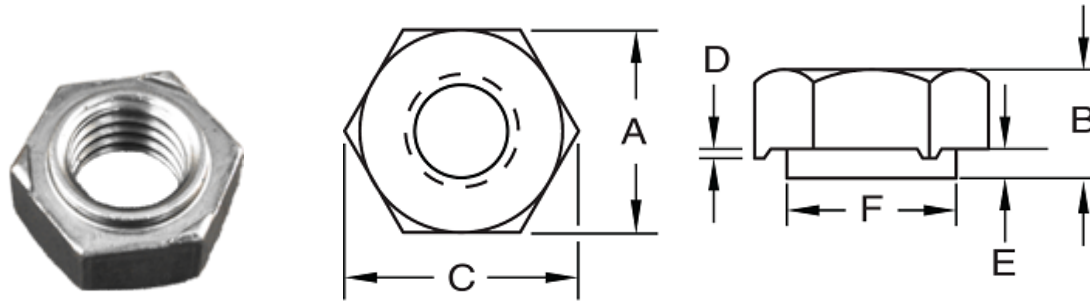

Product	Thread Size	Width (mm)	Thickness (mm)	Pilot Height (mm)	Pilot Diameter (mm)	A (mm)	B (mm)	C Width Across Ref. Only (mm)	D (mm)	E (mm)	F (mm)	Note
BF DIN929M10	M10 X 1.5-6G	17.00	8.0	1.15	12.500	17.00	8.00	18.74	0.650	1.15	12.50	All dimensions are for reference only
BF DIN929M10F	M10 X 1.25-6G	17.00	8.0	1.15	12.500	17.00	8.00	18.74	0.650	1.15	12.50	All dimensions are for reference only
BF DIN929M10Z	M10 X 1.5-6G	17.00	8.0	1.15	12.500	17.00	8.00	18.74	0.650	1.15	12.50	All dimensions are for reference only
BF DIN929M12	M12 X 1.75-6G	19.00	10.0	1.40	14.800	19.00	10.00	20.91	0.800	1.40	14.80	All dimensions are for reference only
BF DIN929M12Z	M12 X 1.75-6G	19.00	10.0	1.40	14.800	19.00	10.00	20.91	0.800	1.40	14.80	All dimensions are for reference only
BF DIN929M14	M14 X 2.0-6G	22.00	11.0	1.80	16.800	22.00	11.00	24.27	1.000	1.80	16.80	All dimensions

												are for reference only
BF DIN929M16	M16 X 2.0-6G	24.00	13.0	1.80	18.800	24.00	13.00	26.51	1.000	1.80	18.80	All dimensions are for reference only
BF DIN929M16L	M16 X 2.0-6G	24.00	13.0	1.80	18.800	24.00	13.00	26.51	1.000	1.80	18.80	All dimensions are for reference only
BF DIN929M16Z	M16 X 2.0-6G	24.00	13.0	1.80	18.800	24.00	13.00	26.51	1.000	1.80	18.80	All dimensions are for reference only
BF DIN929M3	M3 X 0.5-6G	7.50	3.0	0.55	4.500	7.50	3.00	8.15	0.250	0.55	4.50	All dimensions are for reference only
BF DIN929M3Z	M3 X 0.5-6G	7.50	3.0	0.55	4.500	7.50	3.00	8.15	0.250	0.55	4.50	All dimensions are for reference only
BF DIN929M4	M4 X 0.7-6G	9.00	3.5	0.65	6.000	9.00	3.50	9.83	0.350	0.65	6.00	All dimensions are for reference only
BF DIN929M4L	M4 X 0.7-6G	9.00	3.5	0.65	6.000	9.00	3.50	9.83	0.350	0.65	6.00	All dimensions are for reference only
BF DIN929M4Z	M4 X 0.7-6G	9.00	3.5	0.65	6.000	9.00	3.50	9.38	0.350	0.65	6.00	All dimensions are for reference only
BF DIN929M5	M5 X 0.8-6G	10.00	4.0	0.70	7.000	10.00	4.00	10.95	0.400	0.70	7.00	All dimensions are for reference only
BF DIN929M5Z	M5 X 0.8-6G	10.00	4.0	0.70	7.000	10.00	4.00	10.95	0.400	0.70	7.00	All dimensions

													are for reference only
BF DIN929M6	M6 X 1.0-6G	11.00	5.0	0.75	8.000	11.00	5.00	12.02	0.450	0.75	8.00	All dimensions are for reference only	
BF DIN929M6Z	M6 X 1.0-6G	11.00	5.0	0.75	8.000	11.00	5.00	12.02	0.450	0.75	8.00	All dimensions are for reference only	
BF DIN929M8	M8 X 1.25-6G	14.00	6.5	0.90	10.500	14.00	6.50	15.38	0.500	0.90	10.50	All dimensions are for reference only	
BF DIN929M8Z	M8 X 1.25-6G	14.00	6.5	0.90	10.500	14.00	6.50	15.38	0.500	0.90	10.50	All dimensions are for reference only	

**Material:** C1010 High-Welding Quality, Low Carbon Steel  
**Finish:** Plain, Unless Specified  
**Threads:** ASME B 1.13M-2005



**Buckeye Fasteners Company**  
5250 West 164th Street • Brook Park, Ohio 44142-1597  
**(800) 437-1689 • Fax: (216) 267-3228**  
buckeyefasteners.com • info@buckeyefasteners.com  
© 2024 Buckeye Fasteners Company • All Rights Reserved

